

## Serving all of Whidbey Island

# First American Properties



## Features:

- **Signalized Intersection on Highway 20**
- **Freestanding Building**
- **110 Parking Stalls**
- **Captive Whidbey Island Demographics**
- **Less than 2 miles to Naval Air Station Whidbey**
- **8,400 Military Personnel + 18,500 Family Members**
- **2,100 Civilian and Contract Employees**
- **Site Plan on Back**



**For More Information Contact:**

**Steve Ruggiero**  
(206)780-4990 ext. 2  
steve@faponline.net

**See Flyer Back for More Details**



17791 Fjord Drive NE, Suite 160  
Poulsbo, WA 98370  
Phone 206-780-4990 • Fax 206-780-4989 • [www.faponline.net](http://www.faponline.net)

This statement with the information it contains is given with the understanding that all negotiations relating to the purchase, renting, or leasing of the property described above shall be conducted through this office. The above information while not guaranteed has been secured from sources we believe to be reliable.



**SITE**



**21,000 VPD**

**Oak Harbor, WA**



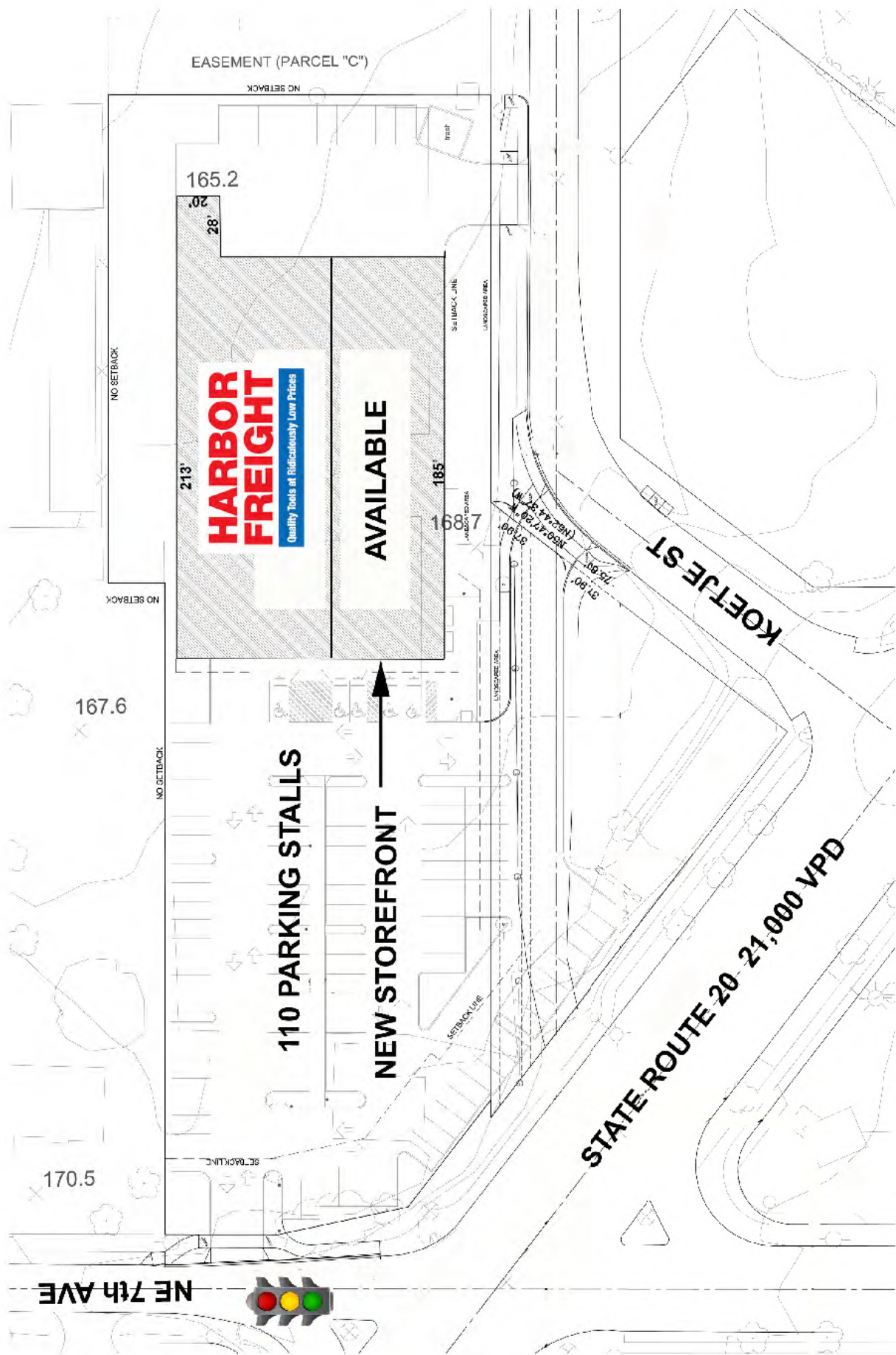

**SITE LAYOUT**

SCALE 1" = 20'

# SAMPLE FLOOR PLAN



NEW STOREFRONT





# Whidbey Island WA

The City of Oak Harbor with a population of 23,000 has long enjoyed it's idyllic Puget Sound setting nestled in the rain shadow of the Olympic Mountains and is surrounded by beautiful harbors and long beaches. Over 60% of the island's 83,159 people are within a 10 mile drive of the city. Oak Harbor is home to all regional shopping for Whidbey and is home to Island County's largest employer, Naval Air Station Whidbey Island. The premier Naval Aviation Installation in the Pacific NW employs 8,400 military personnel, plus 18,500 family members, and 2,100 contract and civillian employees with an economic impact of 1.4 Billion Dollars.

